



17 Wharf Lane

Chesterfield, S41 7NE

Guide Price £140,000



17 Wharf Lane

, Chesterfield, S41 7NE

£140,000 - £150,000 (Guide price)
Conveniently located close to the centre of Chesterfield, and within walking distance of Chesterfield Train Station, is this well presented and deceptively spacious 2 bedroom mid terrace property.

Offering 853 sqft of accommodation over 2 storeys, the property feature 2 reception rooms, including the lounge and dining room, a modern kitchen with integrated oven and hob, bathroom with bath and overhead shower and 2 good sized bedrooms.

Externally, the property benefits from a large south facing garden.





Floor Plan

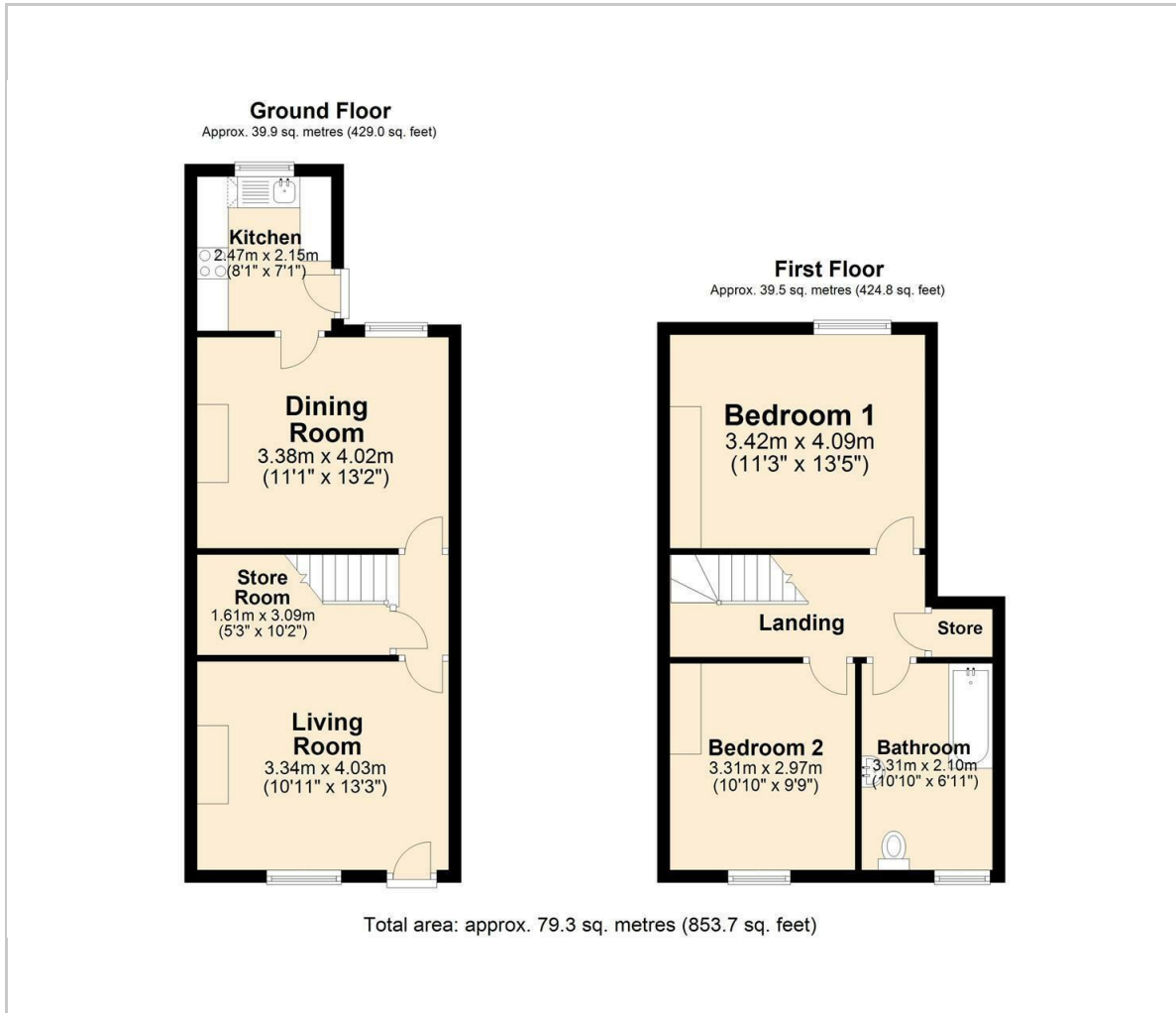

Viewing

Please contact our Chesterfield Office on 01246 567540 if you wish to arrange a viewing appointment for this property or require further information.

These particulars, whilst believed to be accurate are set out as a general outline only for guidance and do not constitute any part of an offer or contract. Intending purchasers should not rely on them as statements of representation of fact, but must satisfy themselves by inspection or otherwise as to their accuracy. No person in this firm's employment has the authority to make or give any representation or warranty in respect of the property.

Area Map

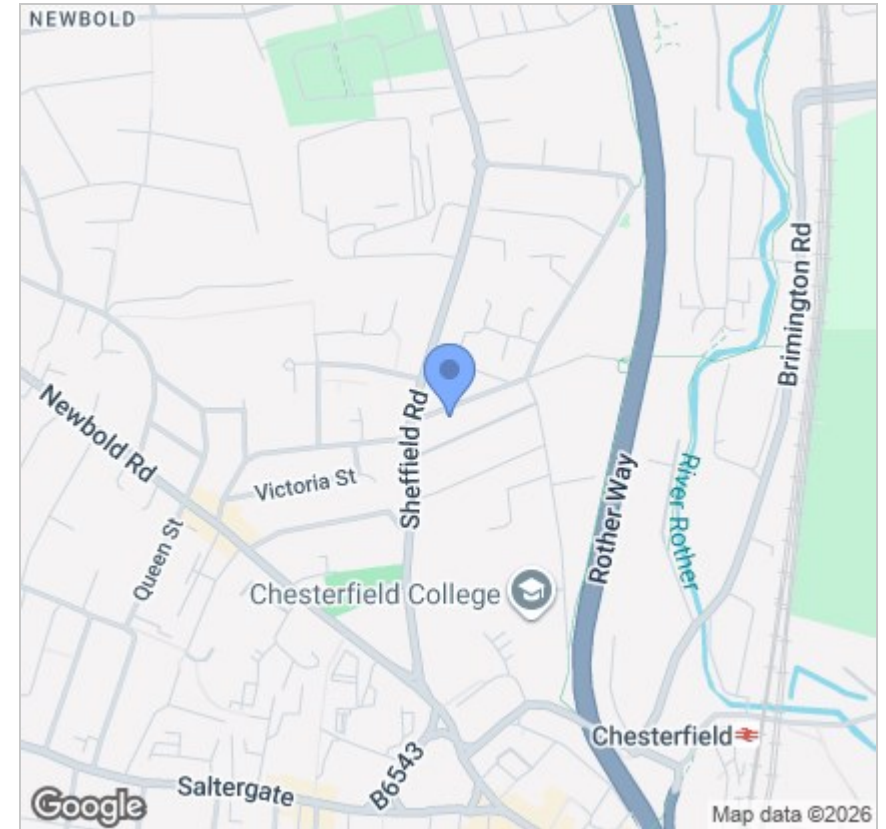

Energy Efficiency Graph

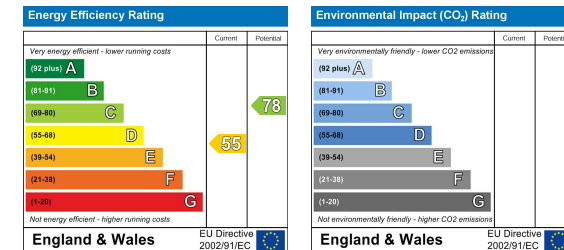

131 Chatsworth Road, Chesterfield, Derbyshire, S40 2AP
T: 01246 567540



E: info@dalesandpeaks.co.uk
www.dalesandpeaks.co.uk